

Modular Potentiometers with Cermet (P11) or Conductive Plastic Elements (PA11)



FEATURES

- CECC 41300
- GAM T1
- P11 version for industrial and military applications
- PA11 version for professional audio applications
- Trimmer version T11/TA11 (see document No. 51021)
- Miniature module size: 12.5 mm square - low current compatibility
- Five shaft diameters and 12 terminal styles
- Multiple assemblies - up to seven modules
- Shaft and panel sealed version
- Up to twenty-one indent positions
- Switch modules
- Concentric shafts
- Motorized version
- Custom designs

RoHS
COMPLIANT

VERSATILE	MODULAR	COMPACT	ROBUST
-----------	---------	---------	--------

ELECTRICAL SPECIFICATIONS			
		PA11	P11
Resistive Element		Conductive plastic	Cermet
Electrical Travel		270° ± 10°	270° ± 10°
Resistance Range*	Linear Law	1 kΩ to 1 MΩ	10 Ω to 10 MΩ
	Non Linear Law	470 Ω to 500 kΩ	100 Ω to 2.2 MΩ
Tolerance	Standard	± 20 %	± 20 %
	On request	-	± 5 % or ± 10 %
Power Rating	Linear Law	0.5 W at + 70 °C	1 W at + 70 °C
	Non linear Laws	0.25 W at + 70 °C	0.5 W at + 70 °C
	Multiple Assemblies	0.25 W at + 70 °C per module	0.5 W at + 70 °C per module
Temperature Coefficient (Typical)		± 500 ppm/°C	± 100 ppm/°C (R ≥ 100 Ω)
Limiting Element Voltage		350 V	350 V
Contact Resistance Variation	Linear Law	1 %	2 % or 3 Ω
End Resistance (Typical)		2 Ω	2 Ω
Independent Linearity (Typical)	Linear Law	± 5 %	± 5 %
Insulation Resistance		10 ⁶ MΩ min.	10 ⁶ MΩ min.
Dielectric Strength		1500 V _{RMS} min.	1500 V _{RMS} min.
Attenuation		90 dB max. and 0.05 dB min.	-
Mechanical Rotational Life		50 000 cycles	50 000 cycles

* Consult Vishay Sfernice for other ohmic values

MECHANICAL SPECIFICATIONS PA11 AND P11

Mechanical Travel:	300° ± 5°
Operating Torque, Single and Dual Assemblies:	
3 mm, 4 mm (1/8") dia. Shafts	0.5 to 1.3 Ncm max. (0.7 to 1.8 oz-inch max.)
6 mm (1/4") dia. Shafts	0.7 to 1.5 Ncm max. (1 to 2.1 oz-inch max.)
Three to Seven Modules (per module):	0.2 to 0.3 Ncm max. (0.3 to 0.45 oz-inch max.)
End Stop Torque:	
3 mm, 4 mm (1/8") dia. Shafts	25 Ncm max. (2.1 lb-inch max.)
6 mm (1/4") dia. Shafts	80 Ncm max. (6.8 lb-inch max.)
Tightening Torque:	
6 mm, 7 mm (1/4") dia. bushings	150 Ncm max. (13 lb-inch max.)
10 mm (3/8") dia. bushings	250 Ncm max. (21 lb-inch max.)
Weight	7 g to 9 g per module (0.25 to 0.32 oz)

VARIATION LAWS

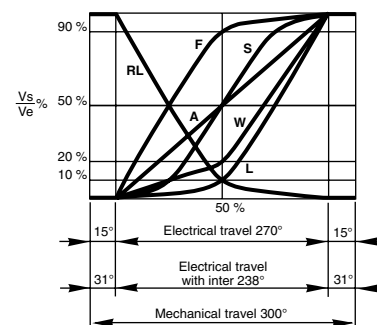



Modular Potentiometers with Cermet (P11) or
Conductive Plastic Elements (PA11)

Vishay Sfernice

DIMENSIONS in millimeters [inches]

PCB PIN OUT A - A₁ - A₂/X - X₁ - X₂/Z - Z₁ - Z₂/W - W₁ - W₂

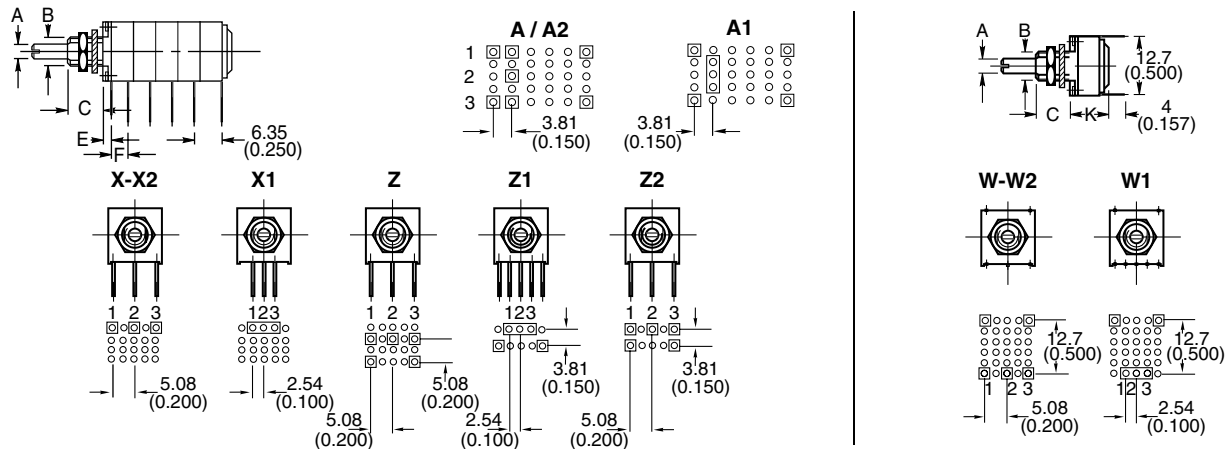

SOLDER LUGS Y

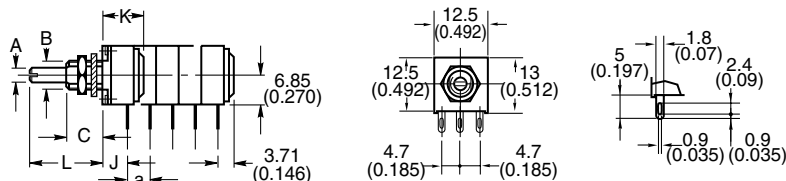

**PANEL AND SHAFT SEALED
TP/QP/VP/2P/7P**

All models have to same
bushing DIA 8 mm - L 8 mm

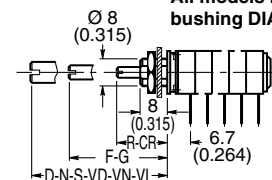

PANEL CUT OUT

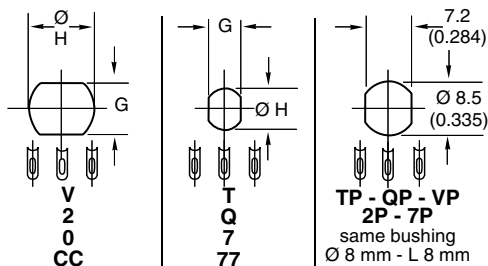

CIRCUIT DIAGRAM

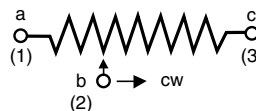

CONCENTRIC SHAFT

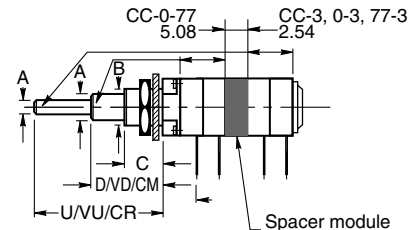

P11/PA11 71
P11/PA11 72
P11/PA11 71H
P11/PA11 72H with spindle baking nut

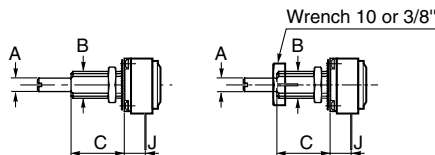

SWITCH: MOMENTARY PUSH OR PUSH-PUSH

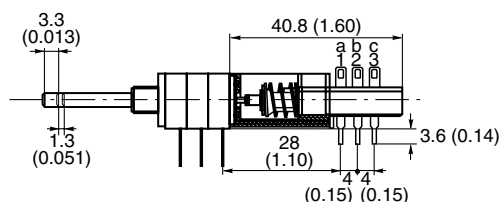

The position of each module is free

Shafts	T	Q	V	CC	7	71	72	2	0	77		
	dimensions mm ± 0.5				dimensions inches ± (0.01)							
A Shafts Ø	3	4	6	3/6	1/8"	1/8"	1/8"	1/4"	1/8"	1/4"	0.07	1/8"
B Bushing Ø	6	7	10	10	1/4"	1/4"	1/4"	3/8"	3/8"			1/4"
C L	8	8	9.5	9.5	1/4"	3/8"	1/2"	3/8"	3/8"			1/4"
J version Y, X, X ₁ , X ₂	5	5	7	7	0.200	0.200	0.200	0.278	0.278			0.200
K	9.1	9.1	11.1	-	0.357	0.357	0.357	0.436	-			-
E version Z	1.8	1.8	3.8	3.8	0.071	0.071	0.071	0.150	0.150			0.071
E version	1.6	1.6	3.6	3.6	0.063	0.063	0.063	0.14	0.14			0.063
F	version Z : 5.08 (0.200)				versions A- A ₁ -A ₂ -Z ₁ -Z ₂ : 3.81 (0.150)							
G Panel	5.2	6.2	8.2	8.2	0.197	0.197	0.197	0.323	.323			0.197
H Cutout Ø	6.5	7.5	10.5	10.5	0.268	0.268	0.268	0.394	0.394			0.268
a	variable 5.08 (0.200)				7.62 (0.300)			10.16 (0.400)				
Thread	M 0.75				32 threads/inch							
Nut	8	10	12	12	0.313	0.313	0.313	0.500	0.500			0.313
Shaft lengths L	Measurement from the mounting face, see ordering procedures											

ENVIRONMENTAL SPECIFICATIONS

	PA11
Operating Temperature Range	- 55 °C + 125 °C
Climatic Category	55/125/21
Sealing	IP64
Storage Temperature	- 55 °C + 125 °C

P11
- 55 °C + 125 °C
55/125/56
IP64
- 55 °C + 150 °C

STANDARD RESISTANCE ELEMENT DATA											
STANDARD RESISTANCE VALUES	P11 CERMET						PA11 CONDUCTIVE PLASTIC LINEAR LAW			CT	
	LINEAR LAW			NON LINEAR LAW						- 55 °C	+ 125 °C
	MAX. POWER AT 70 °C	MAX. WORKING VOLTAGE	MAX. CUR. THROUGH WIPER	MAX. POWER AT 70 °C	MAX. WORKING VOLTAGE	MAX. CUR. THROUGH WIPER	MAX. POWER AT 70 °C	MAX. WORKING VOLTAGE	MAX. CUR. THROUGH WIPER	P11	PA11
Ω	W	V	mA	W	V	mA	W	V	mA	ppm/°C	
22	1	4.69	213.2							± 200	
47		6.85	145.8								
100		10	100								
200		14.8	67.4	0.5							
470		21.6	46.1		15.3	32.7					
1k		31.6	31.6		22.4	22.4	0.5	22.4	22.4		
2.2k		46.9	21.3		33.2	15.1		33.2	15.1		
4.7k		63.5	14.5		48.5	10.3		48.5	10.3		
10k		100	10		79.7	7.07		79.7	7.07		
22k		148.3	6.7		105	4.77		105	4.77		
47k		216.7	4.6		153	3.26		153	3.26		
100k	1	316.2	3.16	0.5	224	2.24	0.5	224	2.24		
220k	0.56	350	1.59	0.26	332	1.51	0.5	332	1.51		
470k	0.26	350	0.75	0.12	350	0.74	0.26	350	0.74		
1M	0.12	350	0.35		350	0.35					
2.2M	0.05	350	0.16								
4.7M	0.02	350	0.07								

POWER RATING CHART

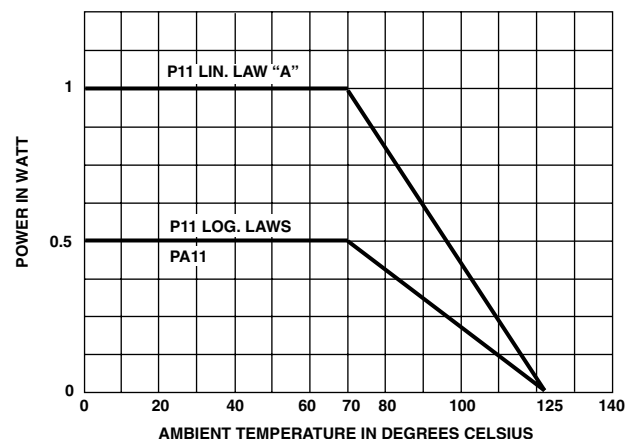

MULTIPLE ASSEMBLIES

Standard assemblies can comprise up to 7 modules in addition to the shaft and bushing module.

Detents module (CV)

Switch modules (RS or RSI)

Potentiometer modules

Spacer module (EV) to increase the distance between rows of pins from 5.06 mm (0.200) to 10.16 mm (0.400).

Screening module, with ground terminal.

The position of each module is free except the push/push, momentary push and motor which has to be the last module.

LINEARITY - CONFORMITY

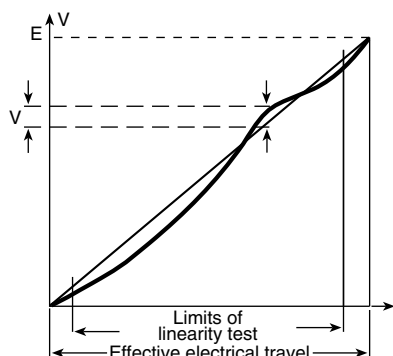

The independent linearity (conformity for the non linear laws) is the maximum gap ΔV between the actual variation curve and the theoretical variation curve the nearest to it. The linearity and the conformity are expressed in percentage of the total applied voltage E

$$\text{linearity conformity} = \frac{\pm \Delta V \text{ max}}{E}$$

They are measured over 90 % of actual electrical travel (centered).

On request linearity can be guaranteed in linear law.

For example: linearity $\pm 2\%$ + J 145 option (see ordering procedure).

INTERLINEARITY - INTERCONFORMITY

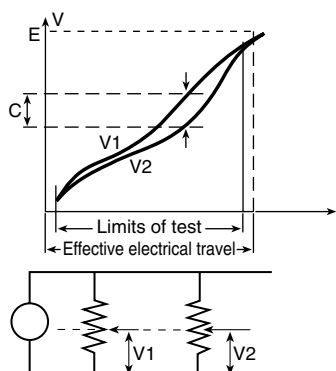

It is the maximum deviation between the actual voltage outputs of 2 or more pot modules in the same assembly. It is expressed as a percentage of the total applied voltage, or preferably in dB attenuation.

Interlinearity is measured between 2 pot modules, over 10 to 90 % of the attenuation.

The interlinearity or interconformity is expressed as a percentage of the total applied voltage :

$$I \% = \frac{|C|}{E}$$

Or in decibels by comparison between outputs V1 and V2

$$I \text{ dB} = 20 \log \frac{V_1}{V_2}$$

PERFORMANCE				
TESTS	CONDITIONS	TYPICAL VALUES AND DRIFTS		
			P11 CERMET	PA11 CONDUCTIVE PLASTIC
Load Life	1000 h at + 70 °C (90'/30')	total resistance shift	$\pm 2\%$	$\pm 10\%$
		contact resistance variation	$\pm 4\%$	$\pm 5\%$
Temperature Cycle	5 cycles - 55 °C to 125 °C	total resistance shift	$\pm 0.2\%$	$\pm 0.5\%$ typical
Moisture	+ 40 °C 93 % relative humidity	total resistance shift insulation resistance	56 days $\pm 2\%$ > 1000 M Ω	21 days $\pm 5\%$ > 10 M Ω
Rotational Life	P11/PA11: 50 000 cycles	total resistance shift contact resistance variation	$\pm 5\%$ $\pm 5\%$	$\pm 6\%$ $\pm 2\%$
Climatic Sequence	Dry heat at + 125 °C/Damp heat Cold - 55 °C/Damp Heat 5 cycles	total resistance shift	$\pm 1\%$	-
Shock	50 G 11 ms 3 shocks - 3 directions	total resistance shift resistance setting change	$\pm 0.2\%$ $\pm 0.5\%$	$\pm 0.2\%$ $\pm 0.5\%$ typical
Vibration	10 - 55 Hz 0.75 mm or 10 G 6 hours	total resistance shift voltage setting change	$\pm 0.2\%$ $\pm 0.5\%$ typical	$\pm 0.2\%$ $\pm 0.5\%$ typical

OPTIONS

MODULES : RS ON/OFF SWITCH

RSI CHANGEOVER SWITCH

The position of each module is free.

RS and RSI rotary switches are housed in a standard P11 module size 12.7 x 12.7 x 5.08 mm (0.5" x 0.5" x 0.2"). They have the same terminal styles as the assembled electrical modules.

CAUTION: Because of the switch actuation travel, the potentiometer total electrical travel is reduced to $240^\circ \pm 10^\circ$

Switch actuation is described as seen from the shaft end.

D: means actuation in maximum CCW position

F: means actuation in maximum CW position

The switch actuation travel is 25° with a total mechanical travel of $300^\circ \pm 5^\circ$.

MODULES :

PUSH/PUSH SWITCH RSPP

MOMENTARY/PUSH SWITCH RSMP

The switches are manufactured by ITT, F.U. series (NE18 series available on request).

They have to be the last element of potentiometer and are linked to electrical module by an interface.

RSPP and RSMP switches are available only with P11/PA11 T-Q or 7 series not with P11/PA11 V or 2 series.

Options :

2 reversing switches F2 4 reversing switches F4

6 reversing switches F6 8 reversing switches F8

Available with shafts R (T), G (Q), CR (7) others shafts on request.

Not available with panel sealed option.

Number of modules before the switch limited to 3 modules.

VALLEY DETENTS

The valley detents mechanism is housed in a standard P11 module. Up to 21 detents position available.

Count detents as follows : 1 for CCW position, 1 for full CW position, plus the other positions forming **equal resistance increments** (linear taper) - **not equal angles**.

Available now : CVID - CVIF - CVIM

CV3 - CV11 - CV21

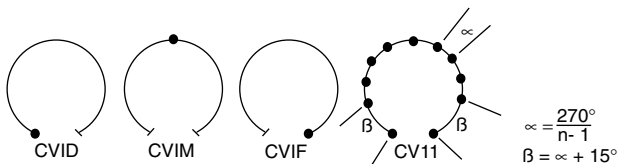

SWITCH MODULES

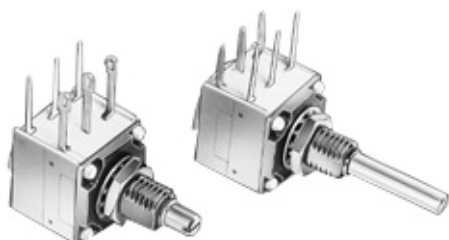

RSD SINGLE POLE SWITCH, NORMALLY OPEN

In full CCW position, the contact between 1 and 3 is open. It is made at the beginning of the travel in CW direction.

RSF SINGLE POLE SWITCH, NORMALLY OPEN

In full CW position, the contact between 1 and 3 is open. It is made at the beginning of the travel in CCW direction.

RSID SINGLE POLE CHANGEOVER

In full CCW position, the contact is made between 3 and 2 and open between 3 and 1. Switch actuation (CW direction) reverses these positions.

RSIF SINGLE POLE CHANGEOVER

In full CW position, the contact is made between 1 and 2 and open between 1 and 3. Switch actuation (CCW direction) reverses these positions.

RSPP F2 : PUSH/PUSH SWITCH WITH TWO REVERSING SWITCHES

Idle position : the contact is made between 1 and 2 and a and b. It is open between 2 and 3 and b and c.

Pushed position: the contact is made between 2 and 3 and b and c. It is open between 1 and 2 and a and b.

Not available on P11V and P11-2.

On request for P11Q and P11-7.

SWITCH SPECIFICATIONS

MODEL		RS - RSI	F2 to F8
Switching Power max.		62.5 VA \cup 15 VA =	50 VA \cup
Switching Current max.		0.25 A 250 V \cup 0.5 A 30 V =	0.5 A \cup
Max. Current Through Element		2 A	2 A
Contact Resistance		30 m Ω	100 m Ω
Dielectric Strength	Terminal to Terminal	1000 V _{RMS}	1500 V _{RMS}
	Terminal to Bushing	2000 V _{RMS}	2000 V _{RMS}
Max. Voltage Operation		250 V \cup 30 V =	250 V \cup
Insulation Resistance Between Contacts		10 ⁶ M Ω	10 ³ M Ω
Life at P max.		10 000 actuations	100 000 actuations
Minimal Travel		25°	3.3 mm to 4.7 mm
Operating Temperature		- 40 °C to + 85 °C	- 20 °C to + 70 °C

ELECTRICAL DIAGRAM

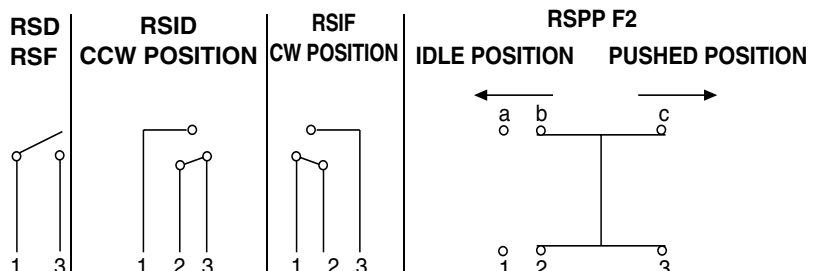

**CENTER TAP "J"**

The extra terminal is a solder lug connected at 50 % of electrical travel and situated in the potentiometer module opposite the terminals.

Center tap short circuit 11° of travel.

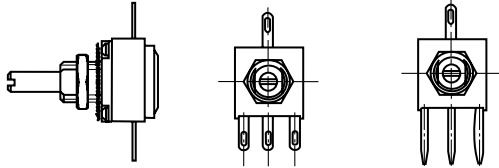
**SHAFTS** (see Ordering Information)

The shaft lengths are always measured from the mounting face.

Standard shafts are designed by a letter code (one or two digits). Shafts slots are aligned to $\pm 10^\circ$ of the wiper position.

CONCENTRIC SHAFTS

The CC or 0 or 77 concentric shaft versions allies the total flexibility of the P11/PA11 modular system to the advantage of having two separate shafts.

The outer 6 mm or 1/4" or 1/8" dia. shaft drives the modules situated immediately behind the panel, before the spacer module.

The inner 3 mm or 1/8" or 0.07" dia. shaft drives the modules situated after the spacer module.

Spacer is available with a choice of two spacer thickness :

5.08 mm designations: CC, 0, 77

2.54 mm designations: CC-3, 0-3, and 77-3. See dimensional drawings on second page of this data sheet

CUSTOM SHAFTS

When special shafts are required - flat, threaded ends, special shaft lengths, etc. a drawing is required.

SPLINED SHAFT "I"**FLATTED SHAFT****PA11/P11 - 2 = VHM****PA11/P11 - 7 = CDM**

Fig. 9

NEUTRAL MODULE "EN"

Neutral or screen module is housed in a standard P11 module. It is used as a screen between two electrical modules.

The leads can be connected to ground.

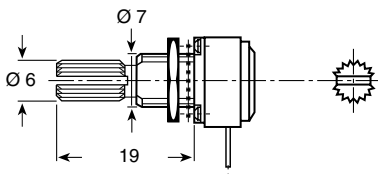
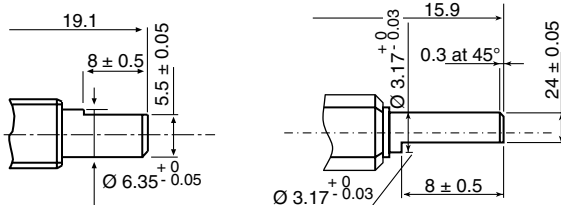
LOCATING PEGS (Anti-rotation lugs)

The locating peg is provided by a plate mounted on the bushing and positioned by the module sides.

Four set positions are available, clock face orientation: 12, 3, 6, 9.

All P11 bushings have a double flat. When panel mounting holes have been punched accordingly, an anti-rotation log is not necessary.

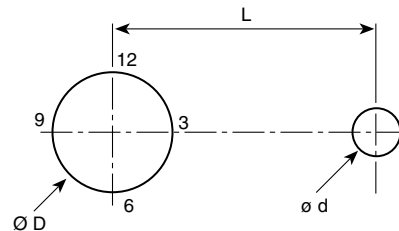

CODE	P11 - PA11					EFFECTIVE HIGH PEG
	VERSION	T-7	V-CC	Q	2-0	
B24	Ø D mm	6.5	10.5	7.5	10	0.7
	Ø d mm	2	2	2	2	
	L mm	6.2	6.2	6.2	6.2	
B30	Ø d mm	2	2	2	2	0.7
	L mm	7.75	7.75	7.75	7.75	
B53	Ø d mm	—	3.5	—	3.5	1.1
	L mm	—	13.5	—	13.5	

TRIMMERS T11

See data sheet document No. 51021

MARKING**POTENTIOMETER MODULE**

VISHAY logo, nominal ohmic value (Ω , $k\Omega$, $M\Omega$), two stars identify PA11 version, tolerance in % - variation law, manufacturing date (four digits), "3" for the lead 3.

SWITCH MODULE

Version, manufacturing date (four digits), "c" for common lead.

INDENT MODULE

Version, manufacturing date (four digits).

P11, PA11

Vishay Sfernice

Modular Potentiometers with Cermet (P11) or
Conductive Plastic Elements (PA11)



ORDERING INFORMATION

P11 Cermet element PA11 Conductive plastic element SERIES	Y Solder lugs - radial X PCB pins - radial Z PCB pins - radial with front support plate A PCB pins - radial with front and back support plates W PCB pins - axial with 2 extra pins - 1 module only - 5.08 mm (.200") pin spacing for X, Z, W pins section 0.9 x 0.3 mm ² (.035" x .012") 1 2.54 mm (.100") pin spacing for X, Z, W pins section 0.6 x 0.3 mm ² (.024" x .012") 2 for X, Z, W pins section 0.6 x 0.3 mm ² (.024" x .012") - 5.08 mm (.200") space between modules 3 7.62 mm (.300") space between modules 4 10.16 mm (.400") space between modules TERMINAL STYLES	B24 Distance from shaft center of 6.2 mm (.244") for all models. Plate thickness of 0.4 mm (.015"). B30 Distance from shaft center of 7.75 mm (.305") for all models. Plate thickness of 0.4 mm (.015"). B53 Distance from shaft center of 13.5 mm (.531") for V, 2, CC and O models. Plate thickness of 0.8 mm (.031"). LOCATING PEGS Locating pegs can be placed at 12, 3, 6 or 9 o'clocks. Not available with panel and shaft sealing option P.	P: All panel sealing versions have a bushing of 8mm dia. and 8 mm length. The shafts K - M - E - CK - CM - CD - CH are not standard. PANEL-SHAFT SEALING OPTION OPTIONS	FROM MOUNTING FACE <table border="1"> <tr> <th>T</th> <th>K</th> <th>M</th> <th>R</th> <th>Dia.</th> <th>Length</th> <th>End Flat</th> <th>End Shaft</th> </tr> <tr> <td>3</td> <td>3</td> <td>3</td> <td>3</td> <td>9.5</td> <td>22</td> <td></td> <td>slotted</td> </tr> <tr> <td>Q</td> <td>E</td> <td>F</td> <td>G</td> <td>4</td> <td>9.5</td> <td></td> <td>slotted</td> </tr> <tr> <td></td> <td></td> <td></td> <td></td> <td>4</td> <td>12.5</td> <td></td> <td></td> </tr> <tr> <td></td> <td></td> <td></td> <td></td> <td>4</td> <td>22</td> <td></td> <td>spined</td> </tr> <tr> <td></td> <td></td> <td></td> <td></td> <td>6</td> <td>19</td> <td></td> <td></td> </tr> <tr> <td>V</td> <td>D</td> <td>N</td> <td>S</td> <td>6</td> <td>16</td> <td></td> <td>slotted</td> </tr> <tr> <td></td> <td></td> <td></td> <td></td> <td>6</td> <td>25</td> <td></td> <td></td> </tr> <tr> <td></td> <td></td> <td></td> <td></td> <td>6</td> <td>50</td> <td></td> <td></td> </tr> <tr> <td>AP</td> <td colspan="7">Custom - specify or quote drawing.</td> </tr> <tr> <td>7</td> <td>CDM</td> <td>CK</td> <td></td> <td>1/8"</td> <td>5/8"</td> <td></td> <td>slotted</td> </tr> <tr> <td></td> <td></td> <td></td> <td></td> <td>1/8"</td> <td>3/8"</td> <td></td> <td></td> </tr> <tr> <td>7</td> <td>CM</td> <td></td> <td></td> <td>1/8"</td> <td>1/2"</td> <td></td> <td>slotted</td> </tr> <tr> <td>71</td> <td>CD</td> <td></td> <td></td> <td>1/8"</td> <td>5/8"</td> <td></td> <td></td> </tr> <tr> <td>72</td> <td>CH</td> <td></td> <td></td> <td>1/8"</td> <td>3/4"</td> <td></td> <td></td> </tr> <tr> <td></td> <td>CR</td> <td></td> <td></td> <td>1/8"</td> <td>7/8"</td> <td></td> <td></td> </tr> <tr> <td>2</td> <td>VD</td> <td></td> <td></td> <td>1/4"</td> <td>5/8"</td> <td></td> <td>slotted</td> </tr> <tr> <td></td> <td>VR</td> <td></td> <td></td> <td>1/4"</td> <td>7/8"</td> <td></td> <td></td> </tr> <tr> <td></td> <td>VN</td> <td></td> <td></td> <td>1/4"</td> <td>1"</td> <td></td> <td></td> </tr> <tr> <td></td> <td>VL</td> <td></td> <td></td> <td>1/4"</td> <td>1.1/2"</td> <td></td> <td></td> </tr> <tr> <td></td> <td>VHM</td> <td></td> <td></td> <td>1/4"</td> <td>3/4"</td> <td></td> <td>flat</td> </tr> <tr> <td>CC</td> <td>D</td> <td></td> <td></td> <td>6</td> <td>16</td> <td></td> <td>plain</td> </tr> <tr> <td>CC-3</td> <td>U</td> <td></td> <td></td> <td>3</td> <td>28.5</td> <td></td> <td></td> </tr> <tr> <td>77</td> <td>CM</td> <td></td> <td></td> <td>1/8"</td> <td>1/2"</td> <td></td> <td>plain</td> </tr> <tr> <td>77-3</td> <td>CR</td> <td></td> <td></td> <td>0.07"</td> <td>0.874"</td> <td></td> <td></td> </tr> <tr> <td>0</td> <td>VD</td> <td></td> <td></td> <td>1/4"</td> <td>5/8"</td> <td></td> <td>plain</td> </tr> <tr> <td>0-3</td> <td>VU</td> <td></td> <td></td> <td>1/8"</td> <td>9/8"</td> <td></td> <td></td> </tr> </table>	T	K	M	R	Dia.	Length	End Flat	End Shaft	3	3	3	3	9.5	22		slotted	Q	E	F	G	4	9.5		slotted					4	12.5							4	22		spined					6	19			V	D	N	S	6	16		slotted					6	25							6	50			AP	Custom - specify or quote drawing.							7	CDM	CK		1/8"	5/8"		slotted					1/8"	3/8"			7	CM			1/8"	1/2"		slotted	71	CD			1/8"	5/8"			72	CH			1/8"	3/4"				CR			1/8"	7/8"			2	VD			1/4"	5/8"		slotted		VR			1/4"	7/8"				VN			1/4"	1"				VL			1/4"	1.1/2"				VHM			1/4"	3/4"		flat	CC	D			6	16		plain	CC-3	U			3	28.5			77	CM			1/8"	1/2"		plain	77-3	CR			0.07"	0.874"			0	VD			1/4"	5/8"		plain	0-3	VU			1/8"	9/8"		
T	K	M	R	Dia.	Length	End Flat	End Shaft																																																																																																																																																																																																																					
3	3	3	3	9.5	22		slotted																																																																																																																																																																																																																					
Q	E	F	G	4	9.5		slotted																																																																																																																																																																																																																					
				4	12.5																																																																																																																																																																																																																							
				4	22		spined																																																																																																																																																																																																																					
				6	19																																																																																																																																																																																																																							
V	D	N	S	6	16		slotted																																																																																																																																																																																																																					
				6	25																																																																																																																																																																																																																							
				6	50																																																																																																																																																																																																																							
AP	Custom - specify or quote drawing.																																																																																																																																																																																																																											
7	CDM	CK		1/8"	5/8"		slotted																																																																																																																																																																																																																					
				1/8"	3/8"																																																																																																																																																																																																																							
7	CM			1/8"	1/2"		slotted																																																																																																																																																																																																																					
71	CD			1/8"	5/8"																																																																																																																																																																																																																							
72	CH			1/8"	3/4"																																																																																																																																																																																																																							
	CR			1/8"	7/8"																																																																																																																																																																																																																							
2	VD			1/4"	5/8"		slotted																																																																																																																																																																																																																					
	VR			1/4"	7/8"																																																																																																																																																																																																																							
	VN			1/4"	1"																																																																																																																																																																																																																							
	VL			1/4"	1.1/2"																																																																																																																																																																																																																							
	VHM			1/4"	3/4"		flat																																																																																																																																																																																																																					
CC	D			6	16		plain																																																																																																																																																																																																																					
CC-3	U			3	28.5																																																																																																																																																																																																																							
77	CM			1/8"	1/2"		plain																																																																																																																																																																																																																					
77-3	CR			0.07"	0.874"																																																																																																																																																																																																																							
0	VD			1/4"	5/8"		plain																																																																																																																																																																																																																					
0-3	VU			1/8"	9/8"																																																																																																																																																																																																																							

SINGLE SHAFT BUSHING <table border="1"> <tr> <th>DIA.</th> <th>LENGTH</th> <th>SHAFT DIA.</th> </tr> <tr> <td>T</td> <td>6</td> <td>8</td> </tr> <tr> <td>Q</td> <td>7</td> <td>8</td> </tr> <tr> <td>V</td> <td>10</td> <td>9.5</td> </tr> <tr> <td>2</td> <td>3/8"</td> <td>3/8"</td> </tr> <tr> <td>7</td> <td>1/4"</td> <td>1/4"</td> </tr> <tr> <td>71</td> <td>1/4"</td> <td>3/8"</td> </tr> <tr> <td>72</td> <td>1/4"</td> <td>1/2"</td> </tr> </table> CONCENTRIC SHAFT <table border="1"> <tr> <th>DIA.</th> <th>LENGTH</th> <th>SHAFT DIA.</th> </tr> <tr> <td>CC</td> <td>10</td> <td>9.5</td> </tr> <tr> <td>O</td> <td>3/8"</td> <td>3/8"</td> </tr> <tr> <td>77</td> <td>1/4"</td> <td>1/4"</td> </tr> </table> <p>*All panel sealing versions have a bushing of 8 mm dia. and 8 mm length</p> SHAFT AND BUSHING	DIA.	LENGTH	SHAFT DIA.	T	6	8	Q	7	8	V	10	9.5	2	3/8"	3/8"	7	1/4"	1/4"	71	1/4"	3/8"	72	1/4"	1/2"	DIA.	LENGTH	SHAFT DIA.	CC	10	9.5	O	3/8"	3/8"	77	1/4"	1/4"	OPTION INDENTS MODULE OPTION SWITCH MODULE 1st POTENTIOMETER MODULE 2nd POTENTIOMETER MODULE 3rd POT MODULE
DIA.	LENGTH	SHAFT DIA.																																			
T	6	8																																			
Q	7	8																																			
V	10	9.5																																			
2	3/8"	3/8"																																			
7	1/4"	1/4"																																			
71	1/4"	3/8"																																			
72	1/4"	1/2"																																			
DIA.	LENGTH	SHAFT DIA.																																			
CC	10	9.5																																			
O	3/8"	3/8"																																			
77	1/4"	1/4"																																			

PA11 7 X13 or B24 P CR CV1M RSD 100 k 20 % A J84 10 k 20 % A J + J84 100 k	THE POSITION OF EACH MODULE IS FREE
--	--

OPTION INDENT MODULE CV1M 1 indent at half travel CV1D 1 indent CCW position CV1F 1 indent CW position CV3 3 indents inc. CW & CCW - - - CV11 11 indents - - - - CV21 21 indents etc. Former CRN version (N-1 equal mechanical angles) available on request.	OPTION SWITCH MODULE RSD Single pole open switch in CCW position - 2 pins RSF Single pole open switch in CW position - 2 pins RSID Single pole chargeover switch in CCW position - 3 pins RSIF Single pole chargeous switch in CW position - 3 pins An assembly can comprise 1 or more switch modules. Pin out RS and RSI is the print out as other assembled modules.	OHMIC VALUE Quote clearly multipliers K - M 10 Ω to 10 MΩ A linear law - cermet 100 Ω to 2.2 MΩ L, F, S non linear laws - cermet Conductive plastic 1 kΩ to 1MΩ A linear law 470 Ω to 500 kΩ non-linear laws	VARIATION LAW <table border="1"> <tr> <th>A</th> <th>Linear</th> </tr> <tr> <td>L</td> <td>CW log 10 %</td> </tr> <tr> <td>F</td> <td>CW reverse log</td> </tr> <tr> <td>S</td> <td>Audio S shape symmetrical log</td> </tr> <tr> <td>W</td> <td>CW log 20 %</td> </tr> <tr> <td>RL</td> <td>CCW log</td> </tr> </table>	A	Linear	L	CW log 10 %	F	CW reverse log	S	Audio S shape symmetrical log	W	CW log 20 %	RL	CCW log	TOLERANCE <table border="1"> <tr> <td>± 20 %</td> <td>Standard</td> </tr> <tr> <td>± 10 %</td> <td>Optional</td> </tr> <tr> <td>± 5 %</td> <td>Optional (cermet only)</td> </tr> </table>	± 20 %	Standard	± 10 %	Optional	± 5 %	Optional (cermet only)	OPTIONS J Center tap J41 Panel sealed bushing 10 mm dia. J44 Interlinearity ± 2 % (linear law) J84 Accuracy of center point of CV1M to ± 2 % (except S law) J123 Linearity ± 3 % (linear law) J145 Linearity ± 2 % (linear law) J152 Marking part number EN Empty module with screen EV Spacer module without pin M Motorized assembly RSPP Push Push switch RSMP Momentary Push switch Servo Electrical travel 300°
A	Linear																						
L	CW log 10 %																						
F	CW reverse log																						
S	Audio S shape symmetrical log																						
W	CW log 20 %																						
RL	CCW log																						
± 20 %	Standard																						
± 10 %	Optional																						
± 5 %	Optional (cermet only)																						



SAP PART NUMBERING GUIDELINES

P	1	1	S	2	T	0	A	B	S	Y	0	0	4	7	0	M	A
MODEL			STYLE	NB	BUSHING	PEG	SHAFT			LEADS			OHMIC VALUE/TOL/LAW OR SPECIAL				
			OF MODULES														

See the end of this data book for conversion tables



Notice

Specifications of the products displayed herein are subject to change without notice. Vishay Intertechnology, Inc., or anyone on its behalf, assumes no responsibility or liability for any errors or inaccuracies.

Information contained herein is intended to provide a product description only. No license, express or implied, by estoppel or otherwise, to any intellectual property rights is granted by this document. Except as provided in Vishay's terms and conditions of sale for such products, Vishay assumes no liability whatsoever, and disclaims any express or implied warranty, relating to sale and/or use of Vishay products including liability or warranties relating to fitness for a particular purpose, merchantability, or infringement of any patent, copyright, or other intellectual property right.

The products shown herein are not designed for use in medical, life-saving, or life-sustaining applications. Customers using or selling these products for use in such applications do so at their own risk and agree to fully indemnify Vishay for any damages resulting from such improper use or sale.