



# Xitanium Constant Current Xtreme

## Xitanium LED Driver Outdoor Dimmable (US)

### Xitanium 75W 0.70A AOCM 1-10 GL-Y sXt

Xitanium Outdoor LED Drivers are available in wattages from 40W to 150W for hard-wire integration into outdoor luminaires for the most rugged applications. These drivers operate to specification under wide temperature and electrical ranges to ensure reliability. 1-10V dimming enables luminaires to be easily connected to a wide variety of sensors and control systems to facilitate dimming, thus maximizing energy savings. Xitanium Xtreme LED drivers provide constant current output, optimal for a single string of LEDs. With exceptional operating efficiency, our drivers significantly reduce energy costs. The Xitanium Xtreme portfolio offers both central and standalone dimming protocols further increasing the energy savings and CO2 reductions achieved with LED lighting. The fully programmable drivers deliver all dimming options and a range of currents in a single driver. System reliability is maximized with intelligent temperature monitoring of the LED light engine. The full portfolio offers maximum flexibility with customizable operating settings, delivering optimal performance tailored for each design.

#### Product data

General Information	
Number Of Products On MCB (16A Type B) (Max)	16

Operating and Electrical	
Input Frequency	50 to 60 Hz
Total Harmonic Distortion IEC (Max)	10 %
Output Current Ripple (Nom)	30 %

Xtanium Constant Current Xtreme

Xtanium LED Driver Outdoor Dimmable (US)

Maximum Efficiency	91 %
Power Factor 100% Load (Min)	0.98
Output Current (Nom)	100-700 mA
Output Current Tolerance (Max)	5 %
Output Current Tolerance (Min)	-5 %
Input Voltage (AC)	120-277 V
Power Factor 50% Load (Min)	0.96
Earth Leakage Current (Max)	350 mA
Input Current (Operating) (Max)	700 mA
Input Power (Nom)	85 W
Inrush Current Peak (Max)	70 A
Output Power (Nom)	20-75 W
Output Voltage	54-107 V
Inrush Current Width To 50% Of Peak	120 µs

Wiring

Control Wire Length	270 mm
Output Wire Length	270 mm
Control Wire Cross Section (Nom)	0.82 mm²
Output Wire Cross Section (Nom)	0.82 mm²
Input Wire Cross Section (Nom)	0.82 mm²

Temperature

T-Ambient (Max)	55 °C
T-Ambient (Min)	-40 °C
T-Case Lifetime (Nom)	72 °C
T-Case Maximum (Max)	80 °C
Module Temperature Protection	Programmable
T-Case Switch Off (Nom)	85 °C

Controls and Dimming	
Control Interface	1-10V
Dimming Range	100-10 %
Lumistep Dimming Time	-
Lumistep Dimming Time After Midpoint	-

Mechanical and Housing

Housing Color	Black
---------------	-------

Approval and Application

Surge Protection (Common/Differential)	4/4 kV
IP Classification	-
Isolation Classification	Class II
Approbation Marks	ENEC certificate CE marking RoHS compliance

Product Data

Full product code	871829122053400
Order product name	Xtanium 75W 0.70A AOCM 1-10 GL-Y sXt
EAN/UPC - Product	8718291999843
Order code	929000708003
Numerator - Quantity Per Pack	1
Numerator - Packs per outer box	12
Material Nr. (12NC)	929000708003
Net Weight (Piece)	0.803 kg

Dimensional drawing

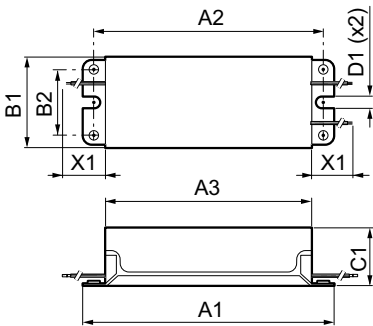

Xtanium 75W 0.7A AOCM 1-10V GL-Y sXt

Product	D1	A2	B2	C1	A1	A3	X1	B1
Xtanium 75W	8.0	151.6	42.9	37.7	167.5	138.1	500	59.1
0.70A AOCM 1-10 GL-Y sXt	mm	mm	mm	mm	mm	mm	mm	mm

**Xitanium Constant Current Xtreme**  
**Xitanium LED Driver Outdoor Dimmable (US)**

