

DC Power Plug Series

KLS1-DC-022A (DC Power Socket)

Technical parameters:

Contact resistance: 0.03Ω, max
 Insulation resistance: 100MΩ, min
 Pressure: AC500V (50Hz) / 1minute
 Rated Load: DC 30V 1A
 Actuating Force: 3~20N
 Life: 5000 times
 Operating Temperature: -30°C ~ 70°C

Material:

Centre Pin : Copper, Nickel Plated
Terminal 5 : Brass, Tin Plated
Terminal 3 : Stainless Steel, Tin Plated
Terminal 2 : Brass, Tin Plated
Housing : PBT
Cover : PBT

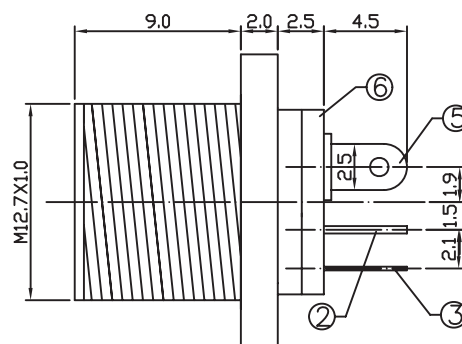
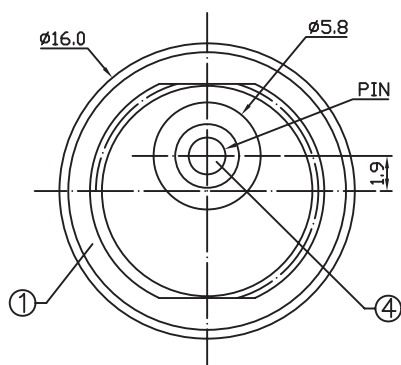

6	COVER	1	PF	
5	CONTACT FOOT	1	C2680	MB:Cu Cu/Sn PLATED
4	PIN	1	C2680	MB:Cu Ni PLATED
3	SPRING	1	65Mn STEEL	MB:Cu Cu/Sn PLATED
2	FLAT PIECE	1	C2680	MB:Cu Cu/Sn PLATED
1	HOUSING	1	PBT	
LTR	PART NAME	QTY	MATERIAL	REMARK

MODEL NO.	DC-022A
SCHEMATIC	
CENTER PIN	Ø 2.0mm
	Ø 2.5mm

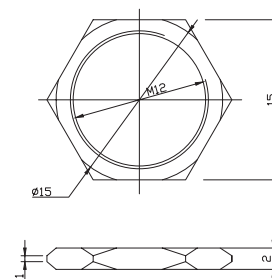
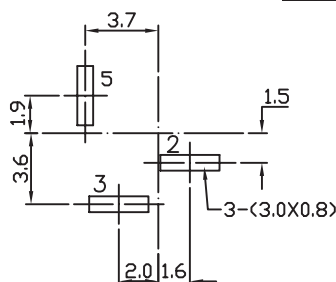

ORDER INFORMATION

Product NO.: KLS1-DC-022A-2.0

Pos. NO. _____

—Center Pin Dimension

DC Power Socket-