

New MTP Module Platform

THE IR ADVANTAGE

- Uses less space than discrete devices
- Simplifies designs
- Mountable on PC board
- Compact package is height compatible with ECONO1 and SEMITOP packages
- Improve ratings of existing systems without upsizing devices
- Completely insulated

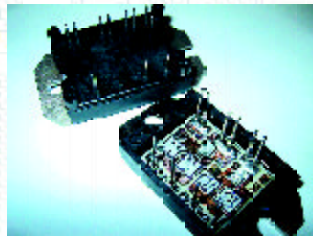

The innovative platform concept is becoming very important in welding applications. A single housing is used to integrate power components, providing higher power density, improved reliability and manufacturing cost savings.

The MTP platform is a multi-chip module that houses a variety of die selections in several configurations. The silicon in these devices has been optimized in terms of conduction and switching characteristics to enhance welding performance.

Using advanced simulation tools and a state-of-the-art lab, International Rectifier's welding team is dedicated to the delivery of integrated solutions and customer support for the welding application.

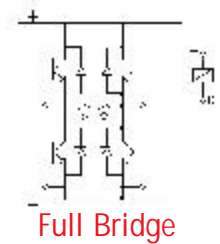
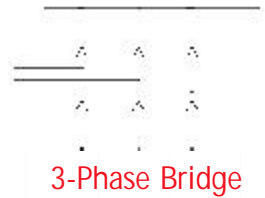

Switch Bridges

Thermistor Option Available

Configuration	Part Number	Switch Type	Diode Type	V_{CES} (V)	I_C @ 25°C (A)	I_C @ 100°C (A)
Full Bridge	25MT060WF	Warp IGBT	HEXFRED	600	50	25
	19MT050XF	FREDFET	Built-in Fast Recovery	500	31	19
	20MT120UF	NPT UltraFast IGBT	HEXFRED	1200	40	20
Half Bridge	50MT060WH	Warp IGBT	HEXFRED	600	100	50
	29MT050XH	FREDFET	Built-in Fast Recovery	500	46	29
	40MT120UH	NPT UltraFast IGBT	HEXFRED	1200	80	40
Low-Side Chopper	50MT060ULS	UltraFast IGBT	HEXFRED	600	100	50

Input Bridges

Configuration	Part Number	V_{RRM} (V)	I_O (A)	Options
3-Phase Bridge	40MT160PA/B	1600	45 @ 100°C	Round/Flat Pins
	70MT160PA/B	1600	75 @ 80°C	Round/Flat Pins
	100MT160PA/B	1600	100 @ 80°C	Round/Flat Pins

www.irf.com For technical support call our Technical Assistance Center in N. America at +1 310 252 7105 and in Europe at +44 208 645 8015

International
IR Rectifier
THE POWER MANAGEMENT EXPERTS

The MTP platform can be used for a wide variety of applications

APPLICATIONS

Welding  UPS  SMPS  Motor Drives

Main Inverter Stage	Machines' Data Current Power Supply Data		Circuit Topology Reference	IR MTP Modules		
	Total Output Power [kW]	Max. Output Current [A _{avg}]		Full Bridge Isw @ Tj=125°C[A _{avg}]	Input Bridge	Full Bridge
For USA						
Single Phase main, 120Vac	2.7	100	11		500V 19MT050XF	
	4.3	160	17		600V 25MT060WF	
Three Phase main,208Vac	5.6	200	22/13	40/70/100MT120P		500V 29MT050XH
	7.5	250	29/17			600V 50MT060WH
	9.6	300	21			
For Europe						
Single Phase main, 230Vac	2.7	100	6		500V 19MT050XF	
	4.3	160	10		600V 25MT060WF	
Three Phase main, 400Vac	5.6	200	13/8	40/70/100MT160P		500V 29MT050XH
	7.5	250	11		1200V 20MT120UF	600V 50MT060WH
	9.6	300	14			1200V 40MT120UH

Input Bridges

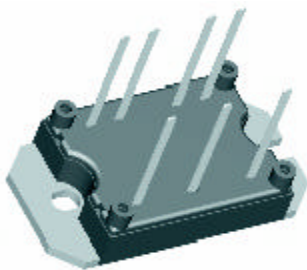

3-Phase Bridge - Flat Pins



3-Phase Bridge - Round Pins

Switch Bridge

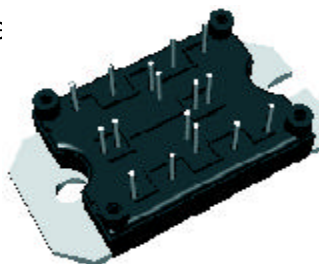

Full Bridge

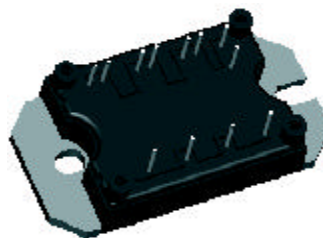

Half Bridge