

20441 : R347,348,JP SHORT
JP7,8 SHORT

Δ : 20MHz NOT USED
() : 20MHz
< > : 50MHz

VERTICAL UNIT (3)

ATEX corp

REV. M. —
DATE 941212

1994. 12. 12

REV. No: 1
DATE: 94.12.12

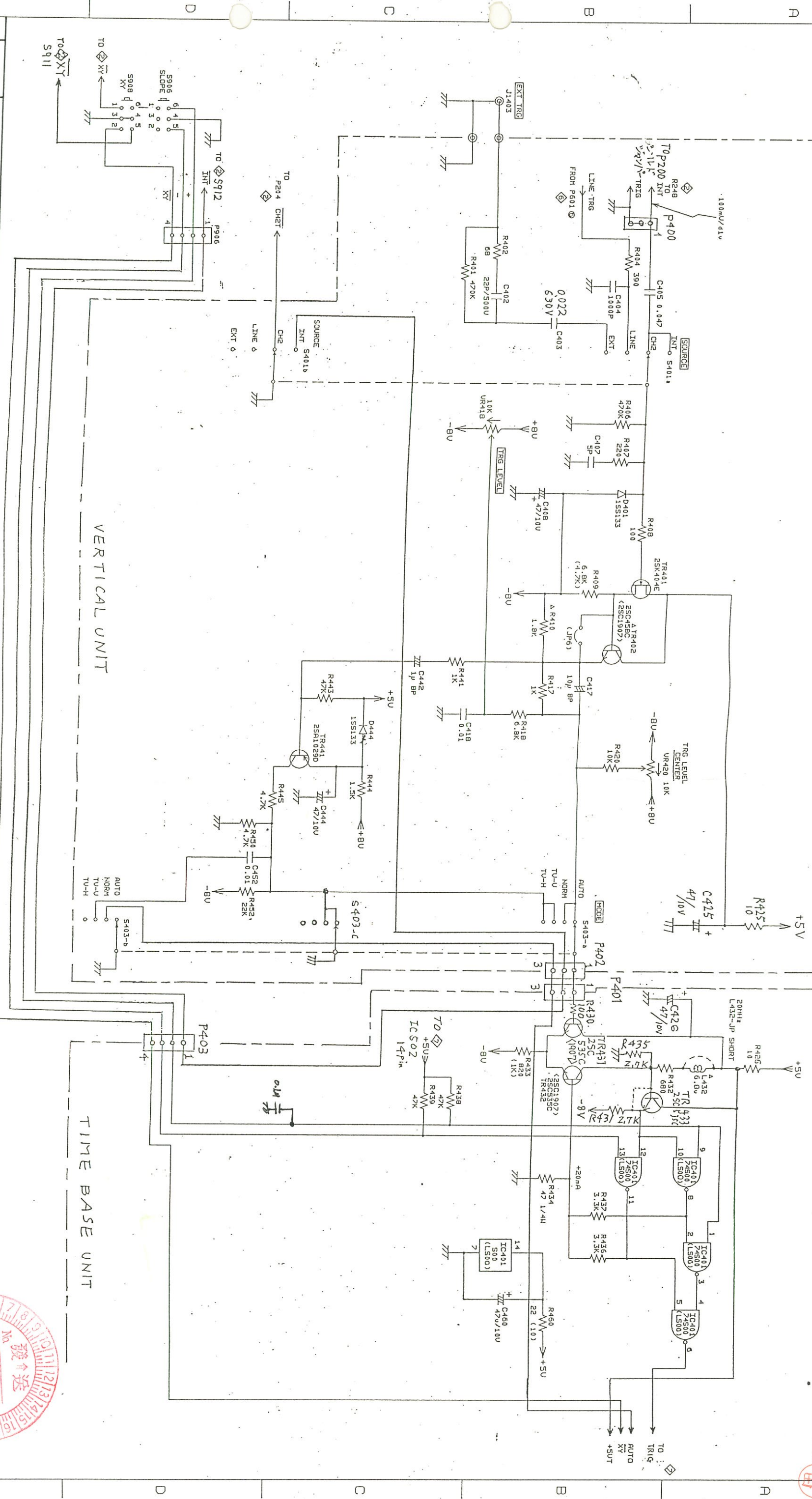

1994. 12. 12
No. 12
發售

TIME BASE UNIT (4)
VERTICAL UNIT (4)

1994. 1. 28
A7EX conf.

95.6.20	0.148 ± 3%
---------	------------

1	2	3	4	5	6	7	8
---	---	---	---	---	---	---	---

96630 77 R1302 4-772
CNC800 Y420

REV. No. 1
DATE 94.12.12

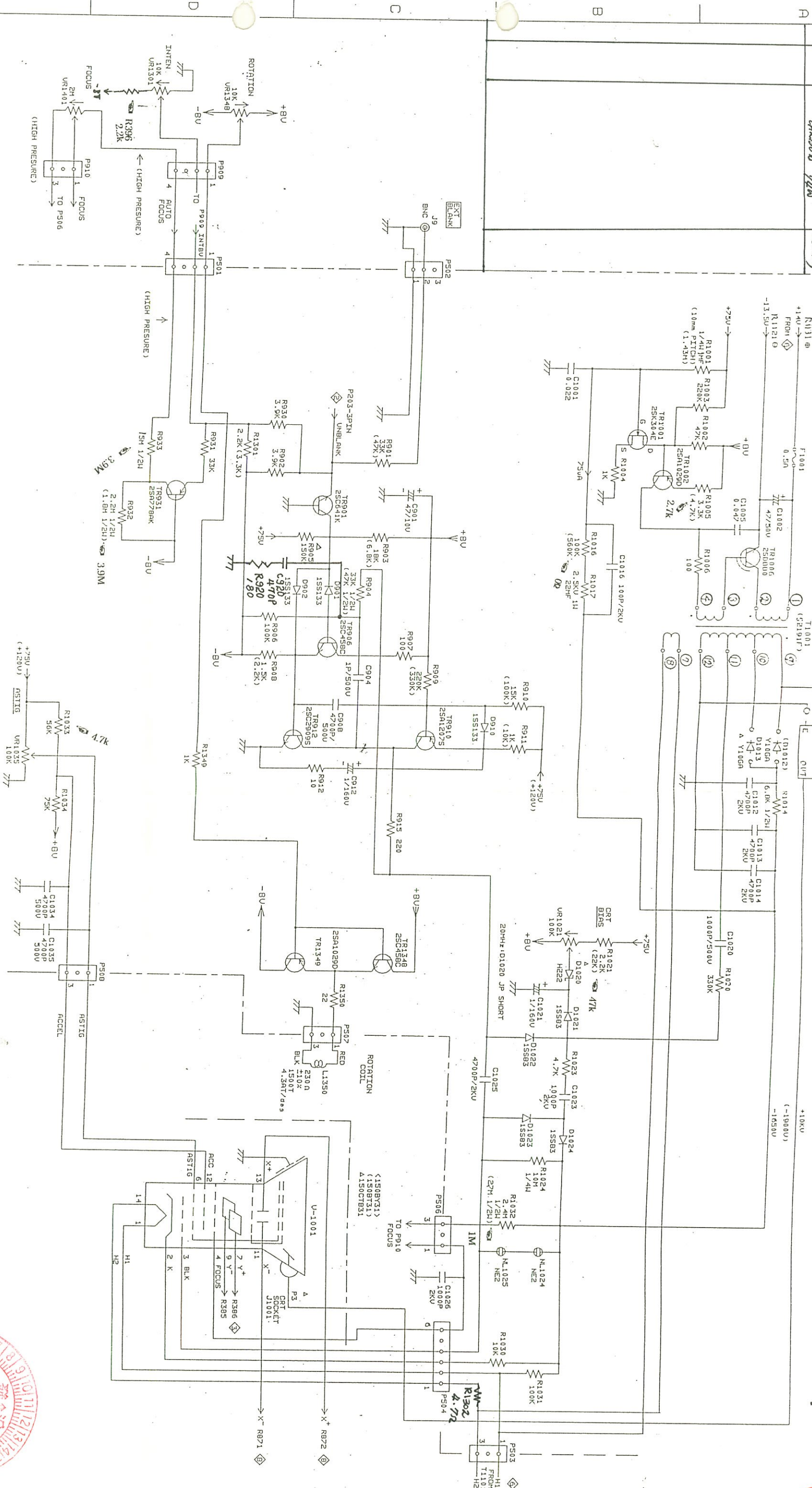

A: 20H14 NOT USED
() : 20H14 ONLY 40, 60H14 NOT USED
() : 60H14 ONLY 20, 40H14 NOT USED

VERTICAL UNIT (S)

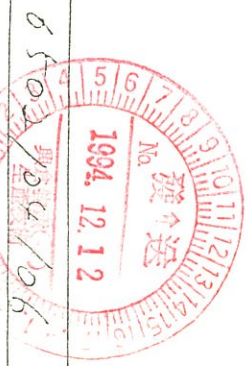

1 2 3 4 5 6 7 8

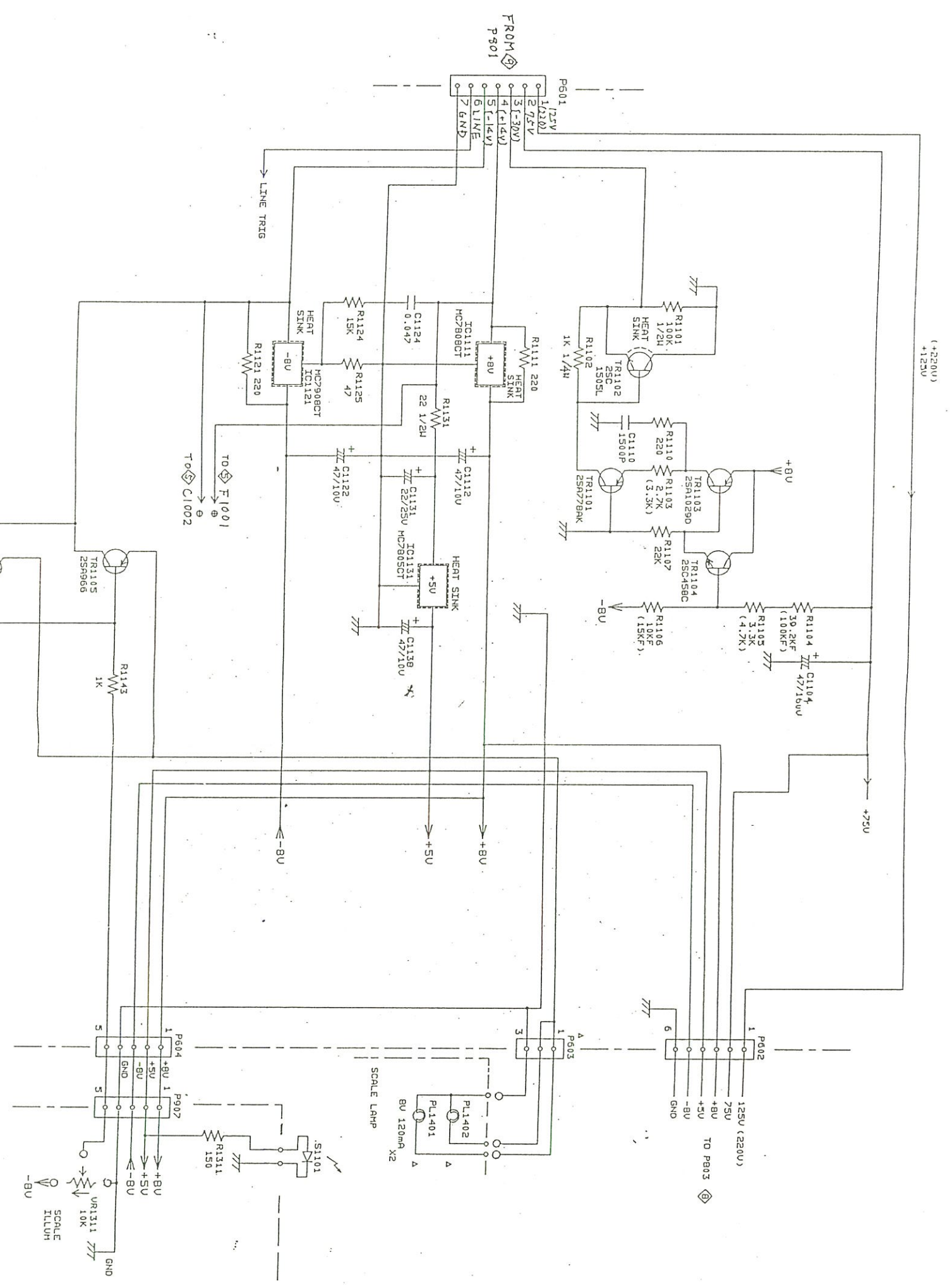

A: 20MHz NOT USED
() : 20MHz ONLY
() : 60MHz



VERTICAL UNIT (6)

ATEX corp.

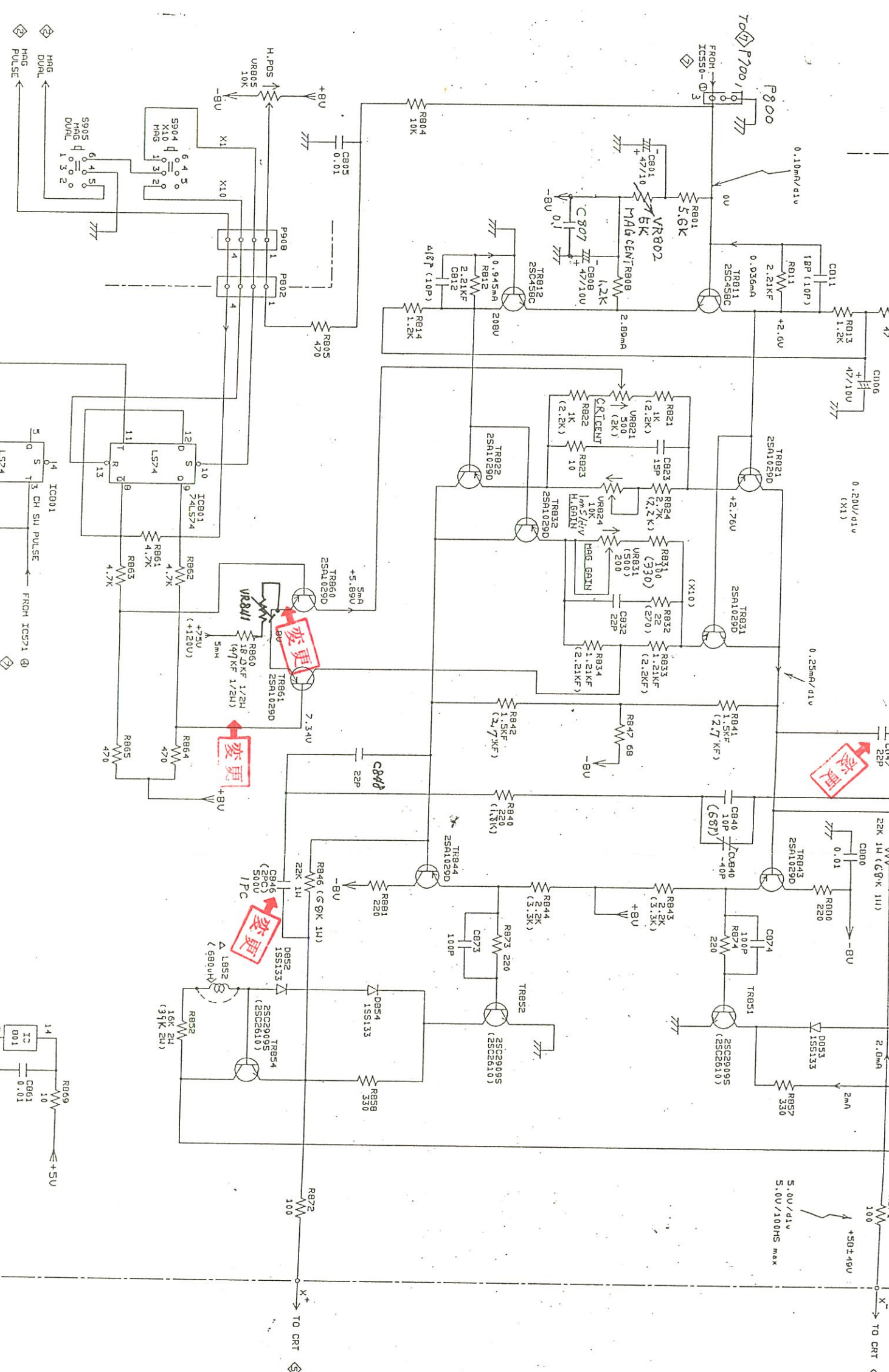
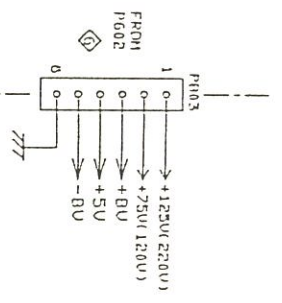

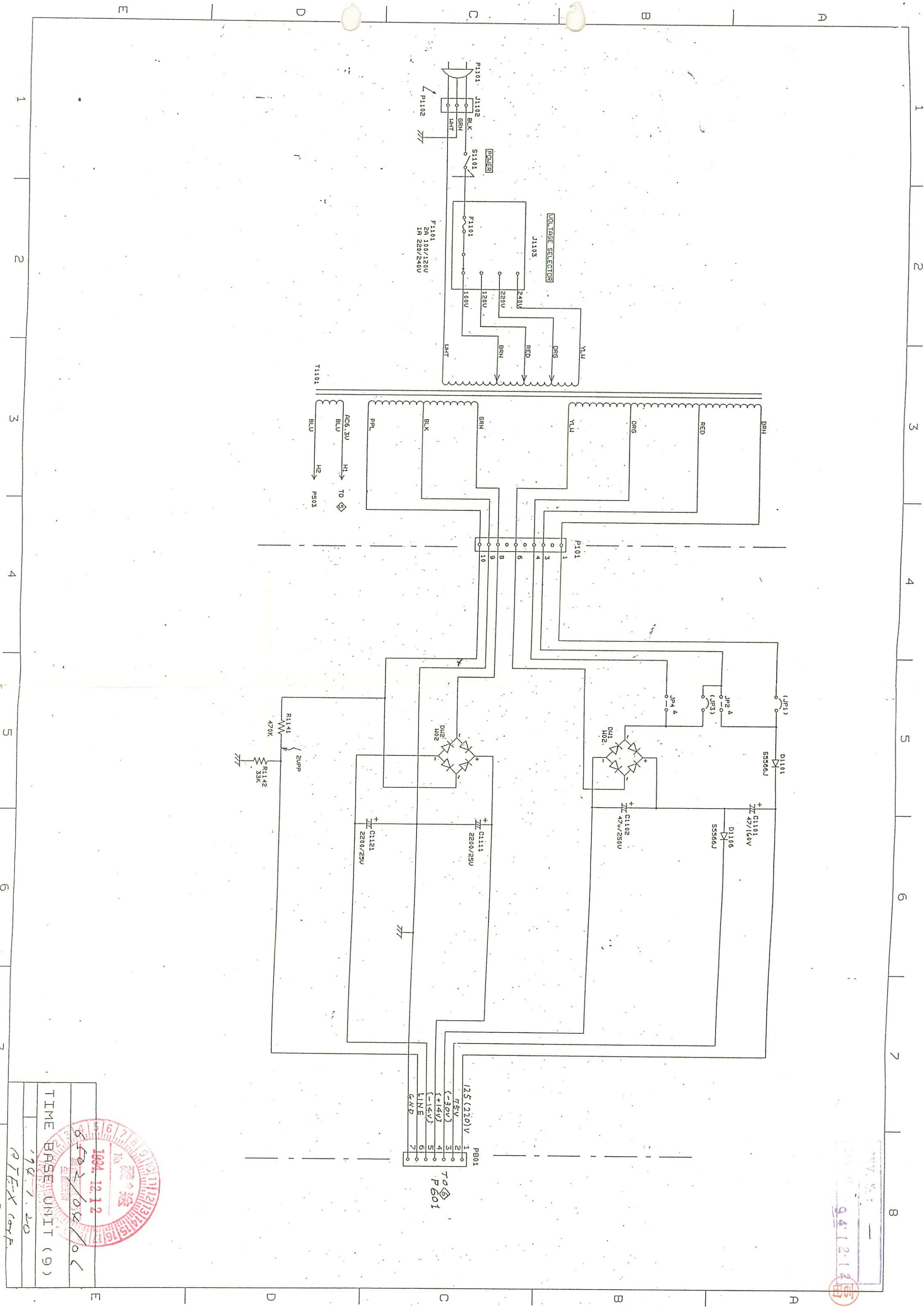

REV. 5: 1
941214

1994. 12. 12
6502/04/00

TIME BASE UNIT (9)

194. 1. 20
ATF-X 107F